

Packing List

Listed below are parts included in this kit. If any parts are missing or damaged, please contact Hustler® Parts Department. Retain these instructions for replacement parts.

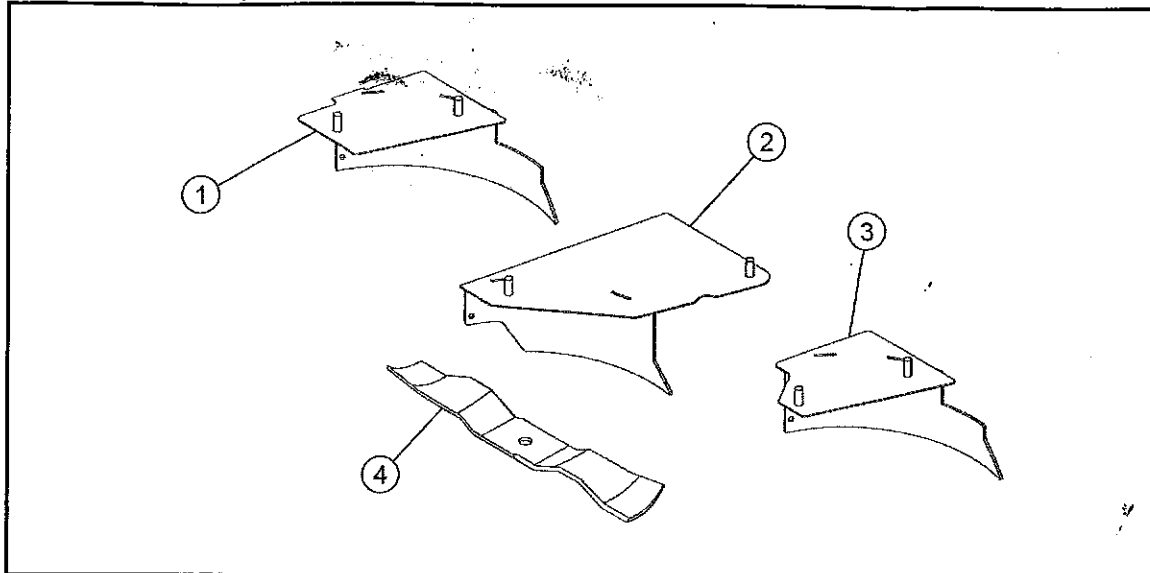

INDEX NO.	PART NO.	DESCRIPTION	QTY
1	116708	RS MULCH BAFFLE	1
2	116705	CENTER MULCH BAFFLE	1
3	116702	LS MULCH BAFFLE	1
4	796623	MULCH BLADE	3

The installation of this kit requires that the mower be placed either on a lift or the front of the mower raised using a hoist. Using a lift will allow for easier access to the underneath side of the deck. However, if a lift is not available, a hoist, with a minimum weight rating of 2000 pounds, can be used to lift the front of the mower high enough to allow access to the underneath side of the deck.

Assembly

1. If using a lift, drive the mower onto the lift; set the park brakes; shut-off the engine; and remove the ignition key. Disconnect the negative battery cable. Raise the lift.
If using a hoist; set the park brakes; shut-off the engine; and remove the ignition key. Disconnect the negative battery cable. Raise the front of the mower enough to allow easy access to the underneath side of the deck. Place the front of the mower securely on jack stands and do not allow the machine to move.



WARNING



Use only appropriate vehicle stands, with a minimum weight rating of 2000 pounds to block the unit up. Use in pairs only. Follow the instructions supplied with the vehicle stands.



WARNING



Exercise caution when working under the deck as the mower blades are extremely sharp. Wrap the blade(s) or wear gloves and use extra caution when servicing them.

2. Remove the existing blades and deck ramps from the underneath side of the deck. Retain the hardware as it will be used for the mulch kit installation. Fig. 1

NOTE: Retain these parts for future use if the mulch kit is removed.

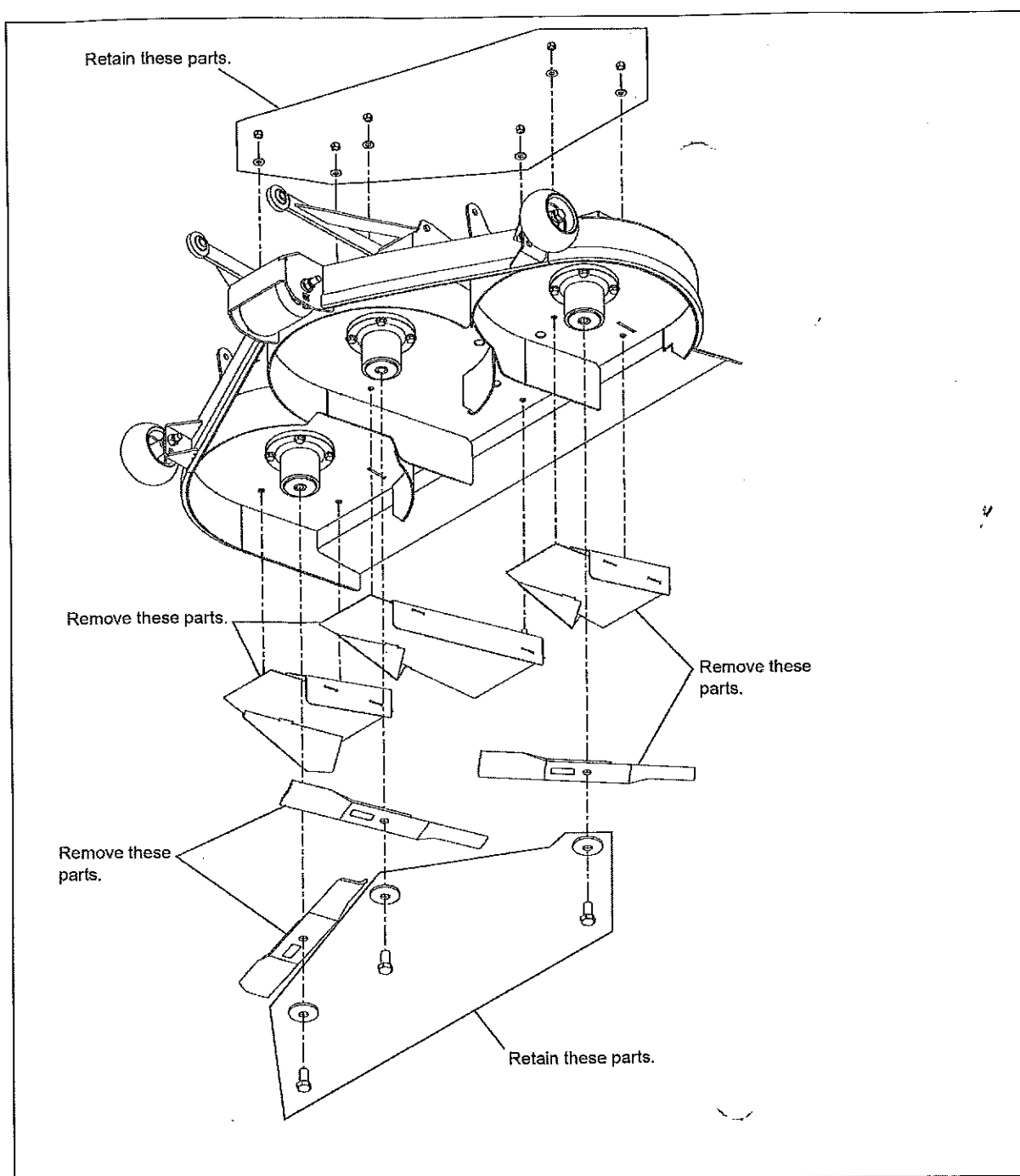

FIG. 1

3. Attach the mulch baffles with the hardware as shown. Fig. 2
4. Attach the new blades to the deck spindles. Torque the blade bolts to 118 ft.-lbs. (160 Nm). Fig. 2



WARNING



Failure to correctly torque the blade bolts may result in the loss of a blade, which can cause serious damage or personal injury.

5. Remove the jack stands and lower the mower.
6. Reconnect the negative battery cable...

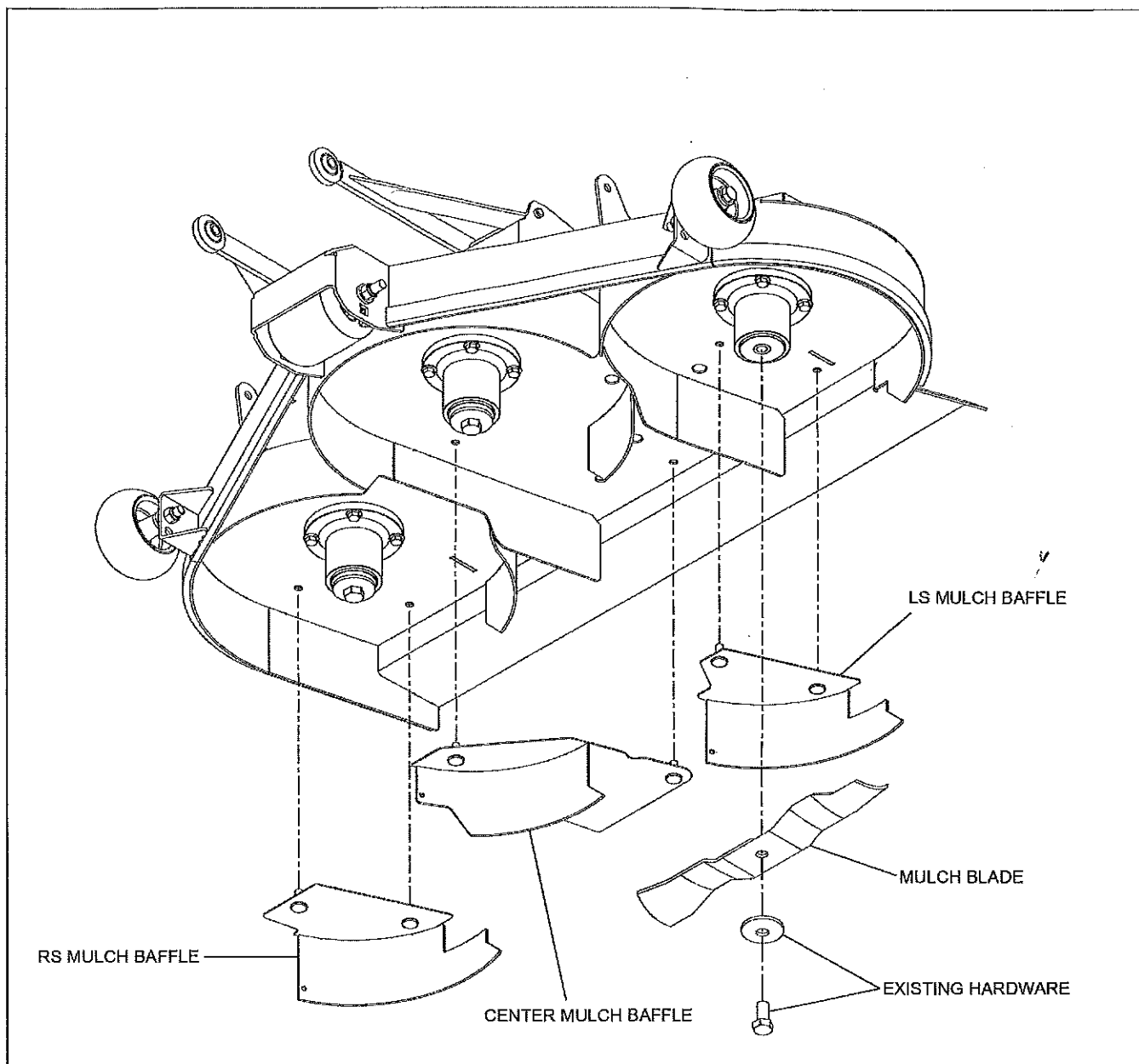

FIG. 2